

Stormont Vail Hospital

1st Floor

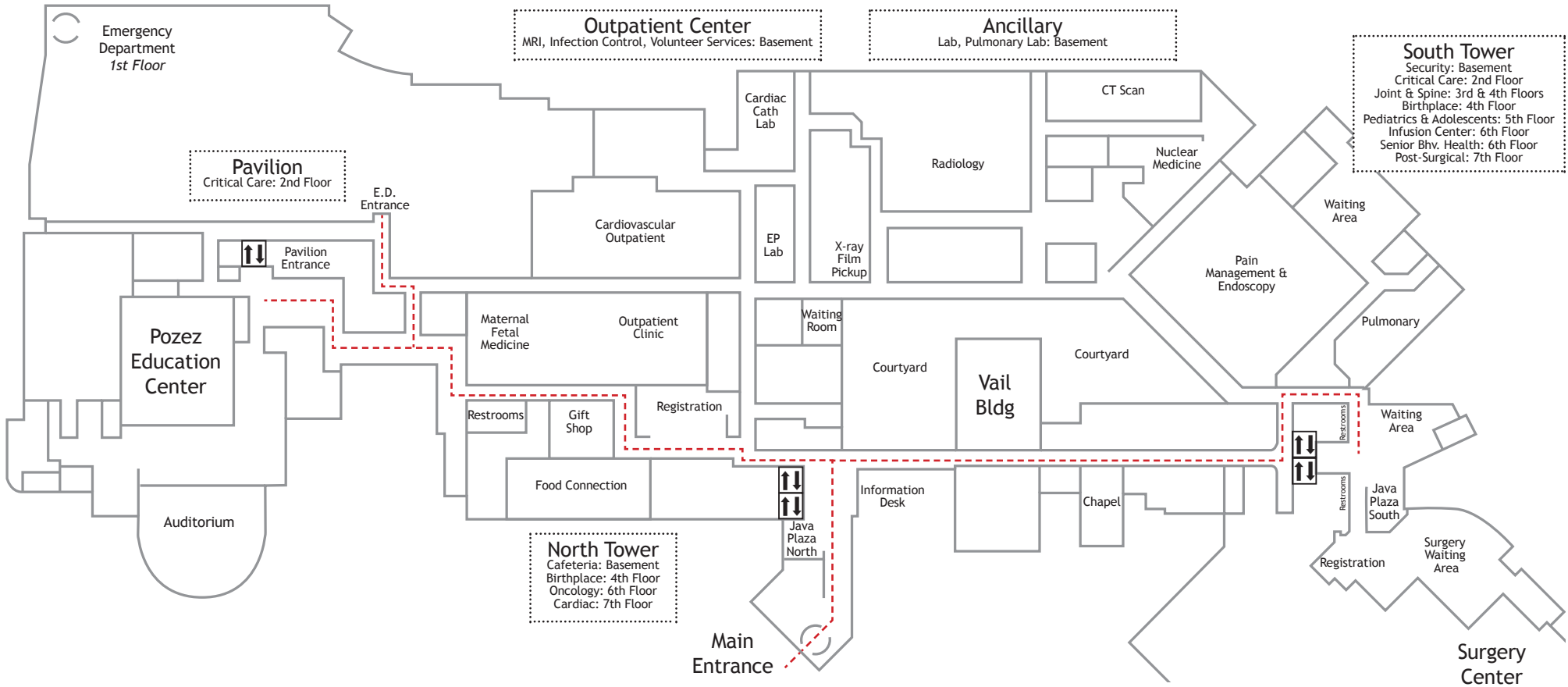

Stormont Vail Hospital

Basement



Pavilion
Emergency Department: 1st Floor
Critical Care: 2nd Floor

Outpatient Center
Cath Lab: 1st Floor

Ancillary
CT Scan, Radiology, Nuclear Medicine: 1st Floor

South Tower
Pain Management & Endoscopy: 1st Floor
Surgery Center: 1st Floor
Critical Care: 2nd Floor
Joint & Spine: 3rd & 4th Floors
Birthplace: 4th Floor
Pediatrics & Adolescents: 5th Floor
Infusion Center: 6th Floor
Senior Bhv. Health: 6th Floor
Post-Surgical: 7th Floor

North Tower
Birthplace: 4th Floor
Oncology: 6th Floor
Cardiac: 7th Floor

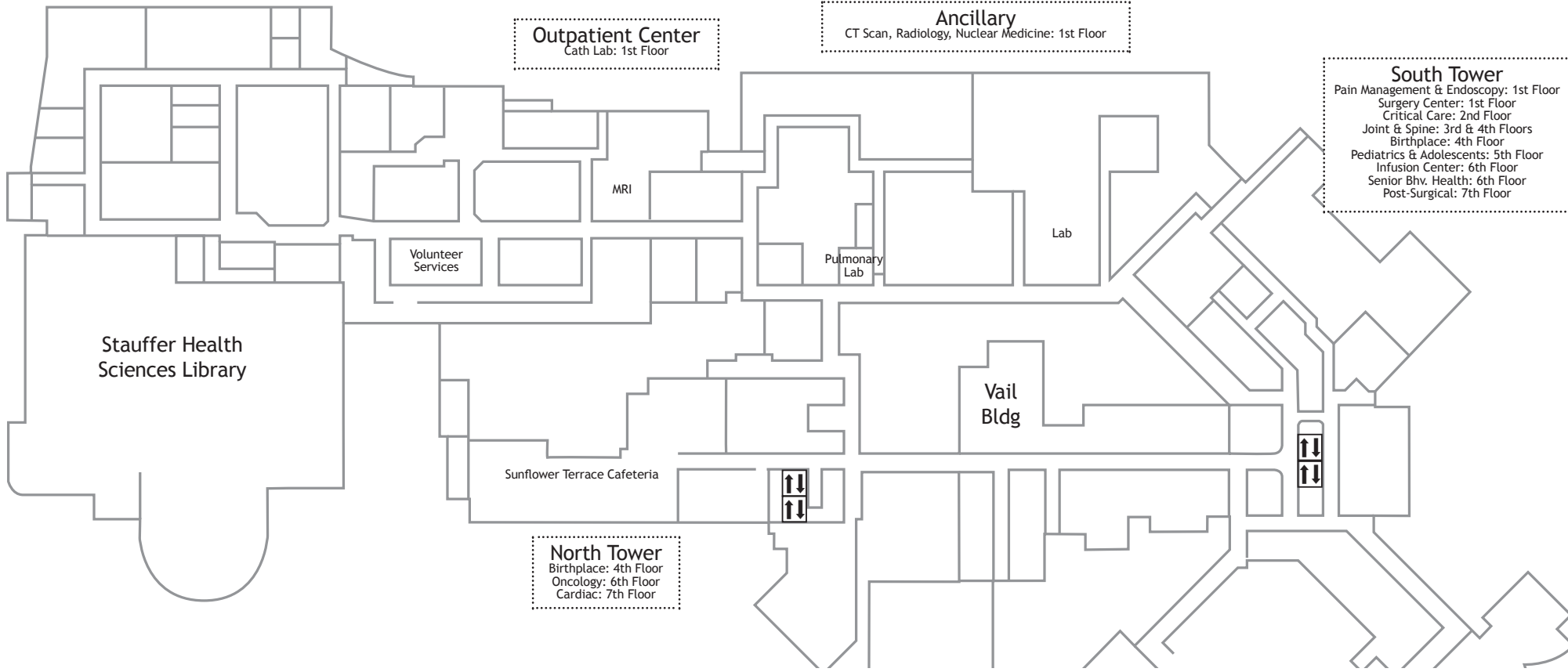

Surgery
Center
Parking